

Vintner Series

Rev. 12/14/09

Diamond Cube G2

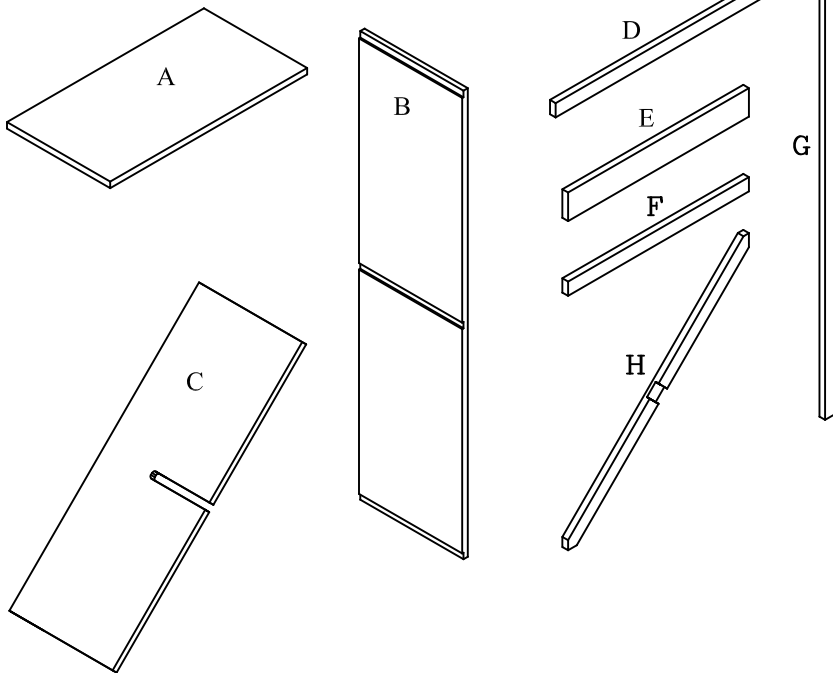
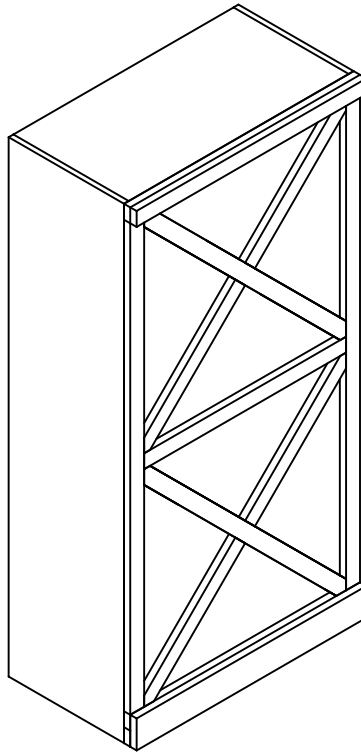

Parts List

#	qty.	description
A	3	Top/Bottom/Middle
B	2	Sides
C	4	Interlock Boards
D	2	Top Trim
E	2	Bottom Trim
F	1	Mid Trim
G	2	Side Trim
H	4	Interlock Face Trim
*	1	Screw driver bit
*	18	1 5/8" #6 Screws
*	1	Bag of nails
*	1	Hardware Pack containing 2 1" Corner Brace 2 plastic anchors 2 1" #8 screws 2 5/8" #6 screws

Wine Cellar Innovations
4575 Eastern Avenue
Cincinnati, Ohio 45226

Phone: (800) 229-9813
Fax: (513) 979-5280
www.winecellarinnovations.com

1. Attach top, bottom, middle and sides together with 1 5/8" #6 Screws.

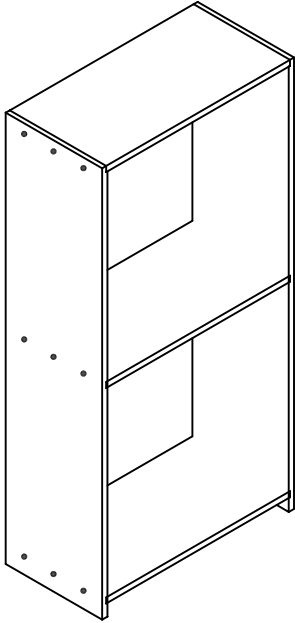

2. Join together 2 interlocking boards to form x-interlocks and slide into openings.

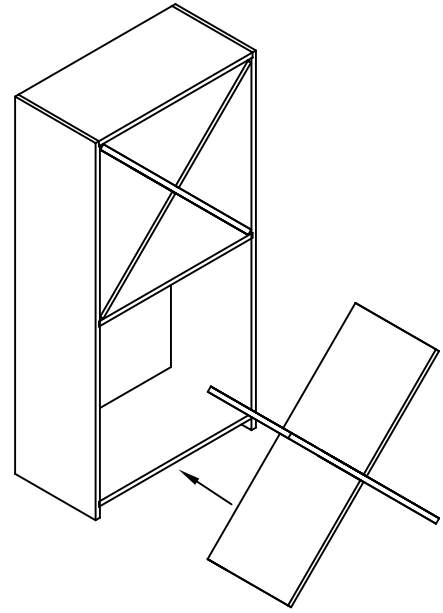

3. Attach (1) top trim, side trim pieces and (1) bottom trim with nails. Attach interlock face trim to interlocks with nails.

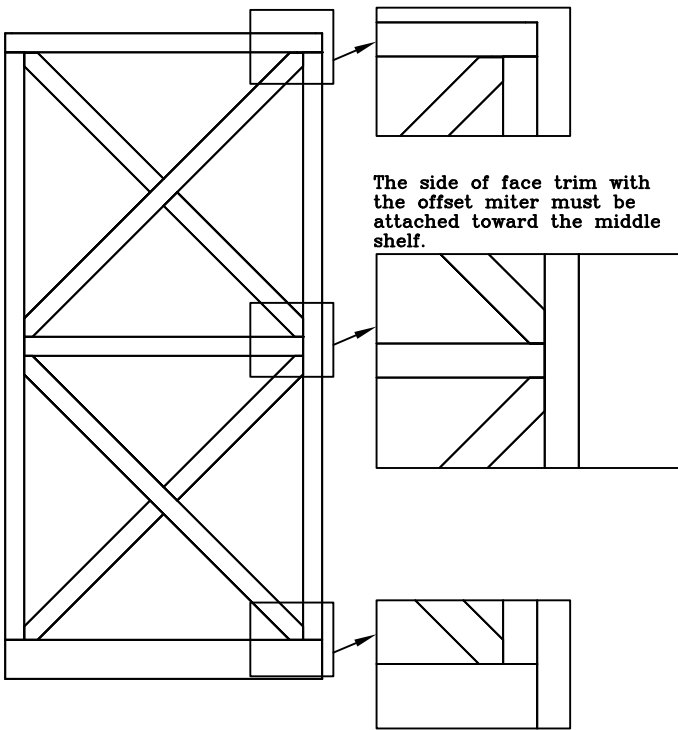

4. Attach second top trim to unit with nails. If kit is going to be stacked with another kit follow trim kit instructions before attaching second bottom trim piece. If not then attach second bottom trim piece with nails.

